

The Floorplan...

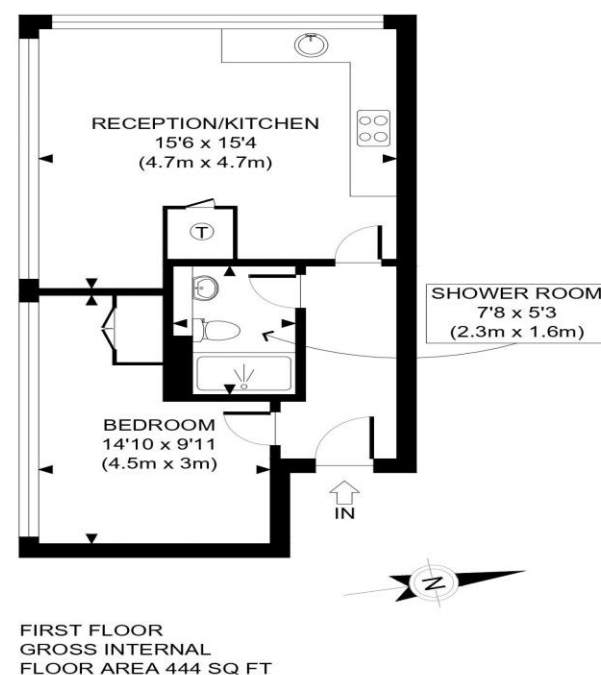

APPROX. GROSS INTERNAL FLOOR AREA: 444 SQ FT/ 41 SQM

This plan is for illustrative purposes only and should be used as such by any prospective client. Whilst every attempt has been made to ensure the accuracy of the Floor Plan contained here, measurements of the doors, windows, rooms and any other items are approximate and no responsibility is taken for any errors, omissions, or misstatement. The services, systems and appliances shown have not been tested and no guarantee as to the operability or efficiency can be given.

PROPERTY PHOTO PLANS .CO.UK
ONE STOP SHOP FOR PROPERTY MARKETING

More Details From...

Call: Brian Cox North Harrow: 020 3866 6640

Email: nhadmin@brian-cox.co.uk

Web: www.brian-cox.co.uk



Consumer Protection from Unfair Trading Regulations 2008 We have not tested any apparatus, equipment, fixtures, fittings or services and so cannot verify that they are in working order or fit for purpose. You are advised to obtain verification from your solicitor or surveyor. References to the tenure of a property are based on information supplied by the seller. We have not had sight of the title documents and a buyer is advised to obtain verification from their solicitor. Items shown in photographs are not included unless specifically mentioned within the sales particulars, but may be available by separate negotiation. We advise you to book an appointment to view before embarking on any journey to see a property, and check its availability.



0203 866 6640
brian-cox.co.uk



Brian Cox Estate Agents are delighted to offer this LARGER THAN AVERAGE one bedroom purpose built ground floor flat to the market! The secure development is accessed via an impressive foyer with porcelain stoneware tiling and seating areas. The apartment features smart, contemporary interiors with fresh, neutral décor, along with high quality flooring and fixtures. The accommodation comprises: Entrance hallway, leading through to all rooms. A large, bright and airy living room with integrated shelving and a kitchen equipped with a range of white, high gloss units, ample counter tops and appliances including a stainless steel oven, hob and extractor, an integrated fridge/ freezer, dishwasher and washing machine.



Offers in Excess of
£200,000

Imperial Drive, Harrow HA2 7HA



In Brief...

- One Bedroom Purpose Built Ground Floor Flat
- Long Lease
- Two Minute Walk To Rayners Lane Tube Station
- Secure Entry Phone System
- EPC Rating C & Council Tax C



The Location...

Nearest Stations ...

- Rayners Lane Station 0.1 miles
- North Harrow Station 0.7 miles
- West Harrow Station 0.7 miles

Talbot Skyline occupies a prime position, within a short stroll of Rayners Lane shops and Metropolitan/ Piccadilly line station, and thus, presents a great opportunity for investment.

